

SFS2000 STUD WALL PANEL SYSTEM

INTRODUCTION:

SFS2000 Stud System is design to meet your most demanding criteria as:

1. Cost effective & value engineering
 - Flexible, easy and easy installation systems which can be pre-installed the aluminum stud frame without the installing the panel, fast installation and suitable for tight completion schedule
 - Optimum cost control design
 - High intensity aluminium skin with honeycomb panel
2. Superior appearance
 - Smooth color roll coated aluminium skin surface gives a perfect appearance
3. Demountable and easy to remodel
 - Using special design profile to install, all using self-taped screw to install with each other, easy to demountable and relocation
 - Easy to change the defect panel, panel-changing can be done with only remove the batten between panels
 - Panel can be uninstalled and relocated, also easy to modify on site
 - High intensity aluminium honeycomb panel, easy for handling during remodel process
 - Reusable system with flexible custom to size
4. Fast delivery and competitive cost
 - SYC provide the fast delivery to meet customer schedule
 - SYC provide high quality product and reasonable price to meet customer requirement
5. Non-combustible material
 - Approved and tested by China National Fire Equipment Quality Supervision Centre which the aluminum honeycomb panel is non-combustible with class B1
 - Equal to standard GB/T9978-1999

6. Suitable for cleanroom up to Class 1
- SFS2000 stud wall panel systems are special design for high end clean room up to class 1

System: Demountable wall panel system

Panel Type: 45 mm thick
Panel surrounding is without close edge optional with T=0.6mm GI coated steel close edge
Combustion property, non-combustible material, according to standard GB5464

Applications: Electronics & Pharmaceutical Cleanroom

Facings: 0.8 mm PE Roll Coated steel skin, with or without Static Dissipative Surface Treatment
Conductivity: $R=10^6\Omega-10^9\Omega$
The surfaces are protected with a film foil (0.04mm) for the prevention of scratches during transport and installation damages.

Color: Grey White (Close to RAL 9016)

Core: Aluminum Honeycomb, T=0.06mm, $\varnothing=17$ mm

Adhesive: Rebon YB2002 (resin) mixed with YB8001 (Hardener) Epoxy Paste Adhesive
Mixing Ratio, YB2002:YB8001=2:1

Panel Dimension: Thickness of the panel is 45mm.

Table 1: Honeycomb Aluminum Panel Specification

Description	Honeycomb Aluminium Panel
Non-Combustible	Class B1
Thermal Conductivity	<0.044 W/mk
Resists Temperatures	>100°C
Water Absorption	Moderate
Compression Resistance	>100kPa
Aluminum Core Thickness	0.06mm
Aluminum Honeycomb Diameter	D=17mm
Compressive Strength	>200 kPa
Flammable Gas Toxicity	Less

The vertical joint between the panels will be sealed with SYC aluminum special design accessories (Refer to joint drawing).

Figure 1: System Detail Drawing

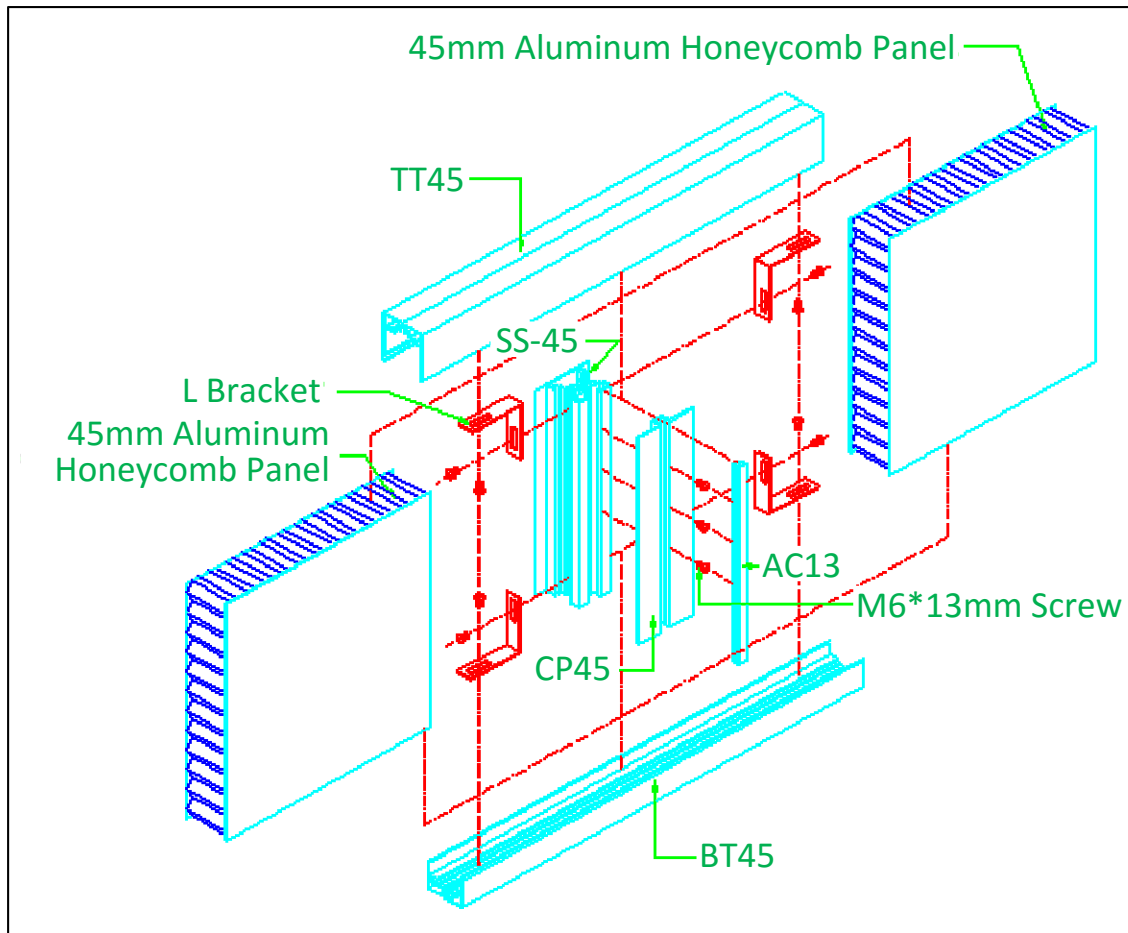

Figure 2: SFS2000 System Drawing (Internal)

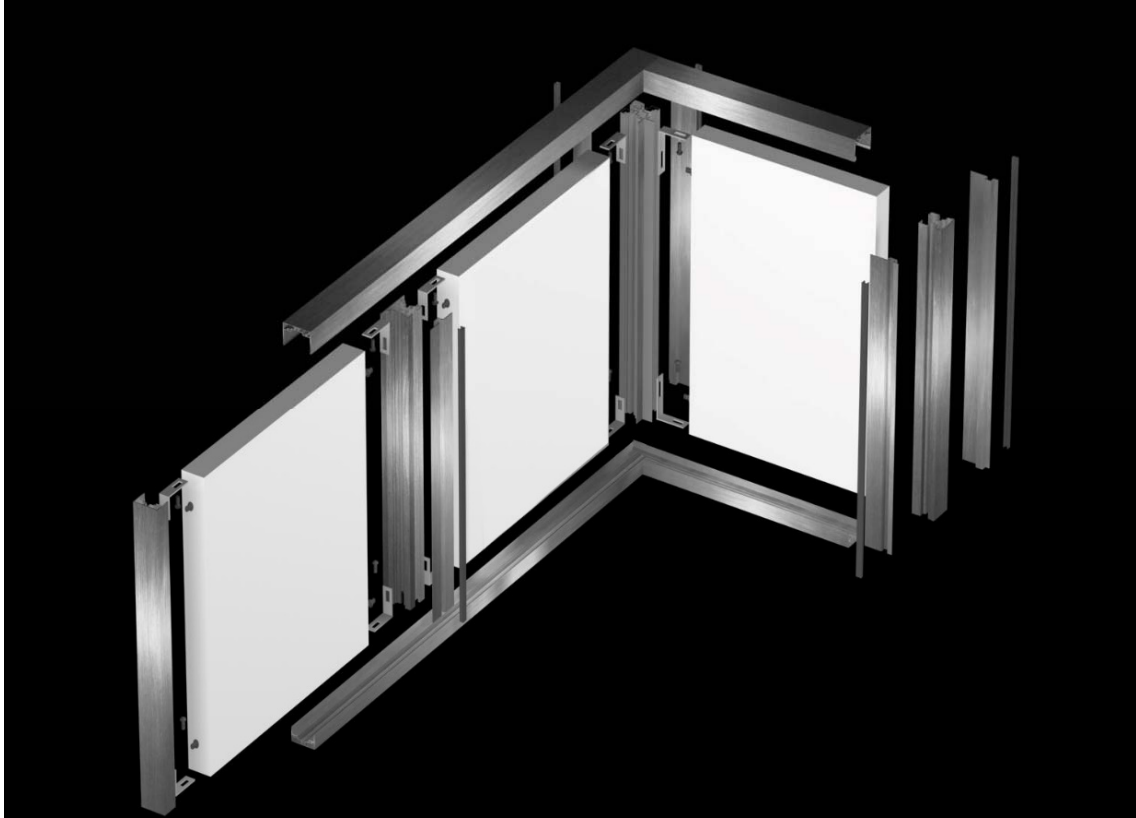

Figure 3: SFS2000 System Drawing (External)

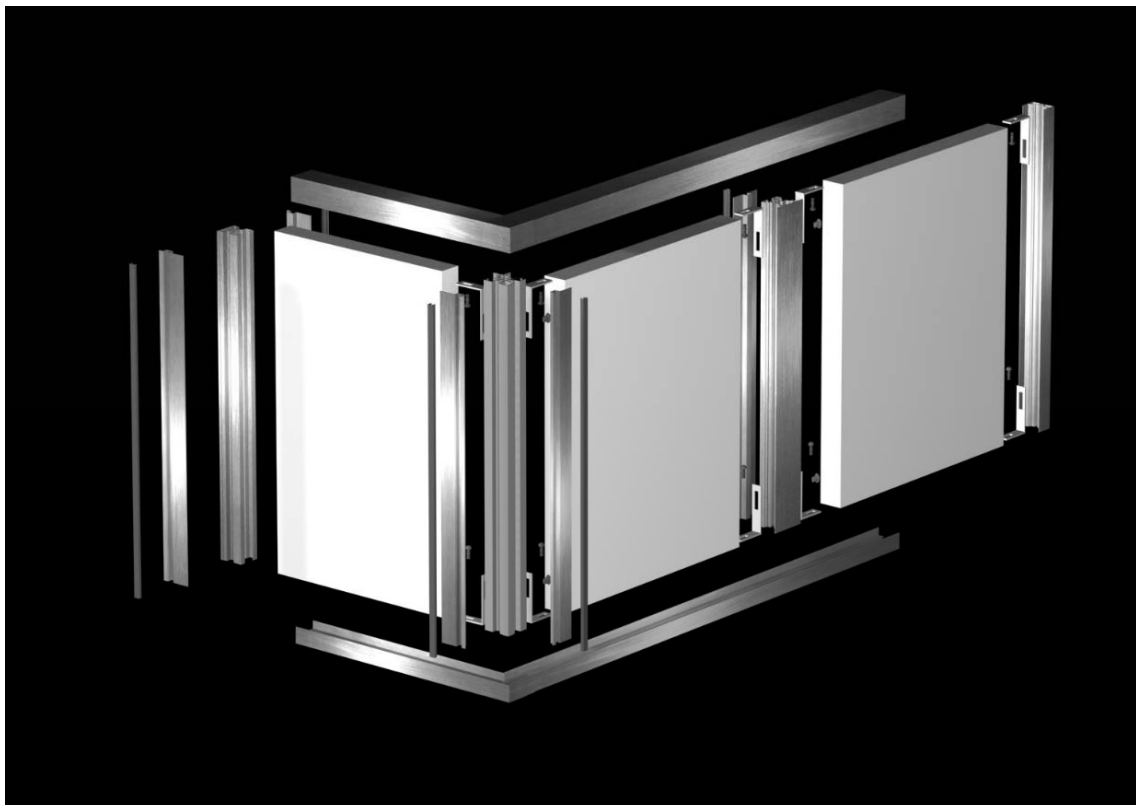

Figure 4: SFS2000 System Panel Top and Bottom Track Joint

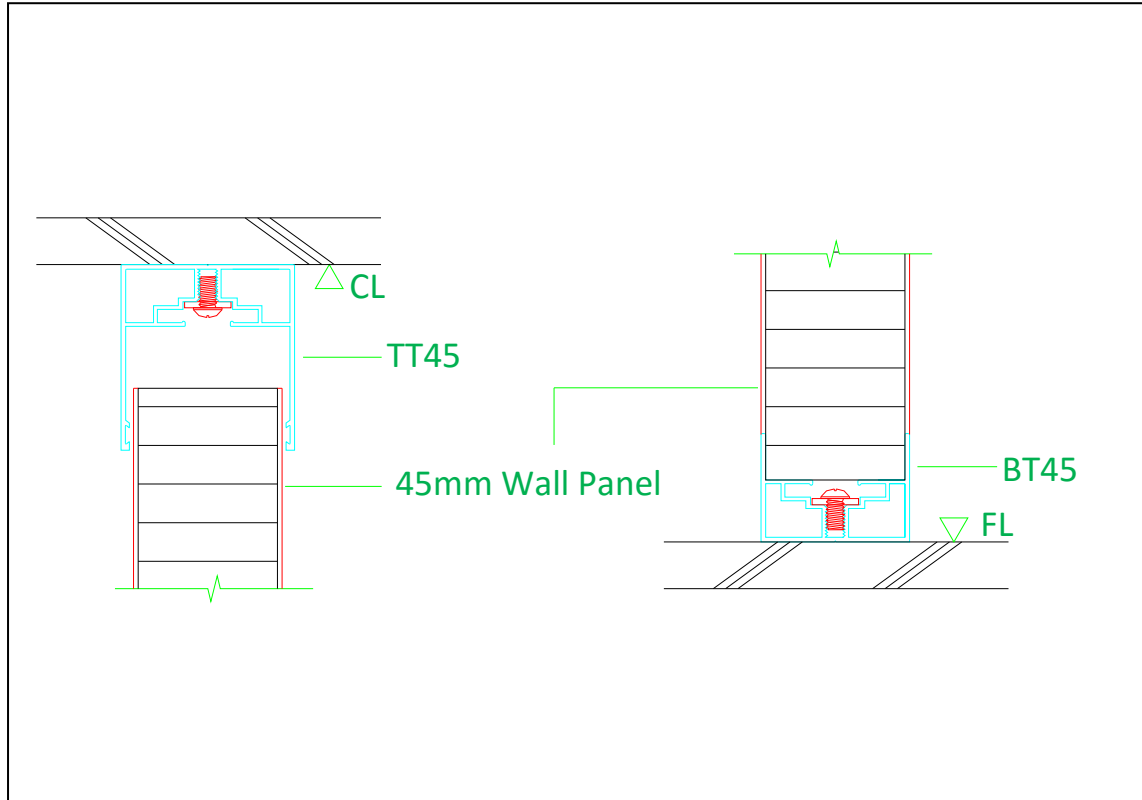

Figure 5: SFS2000 System Window & Panel Joint

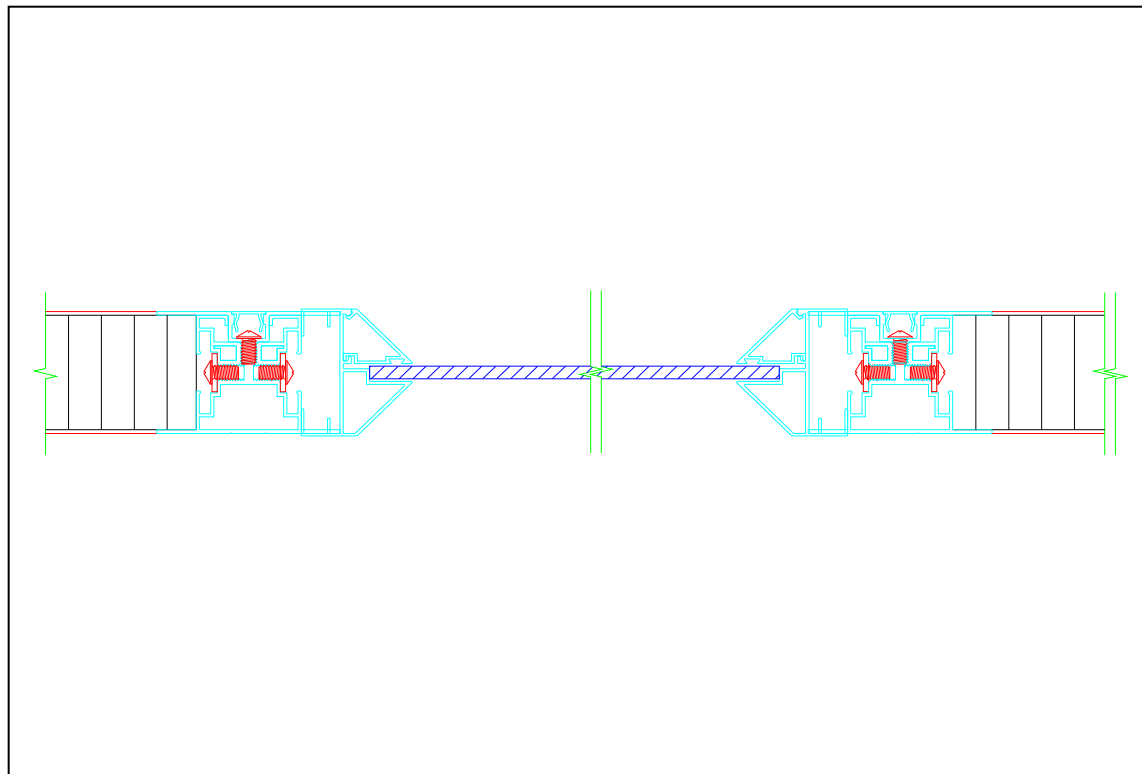

Figure 6: SFS2000 System Corner and End Post Joint

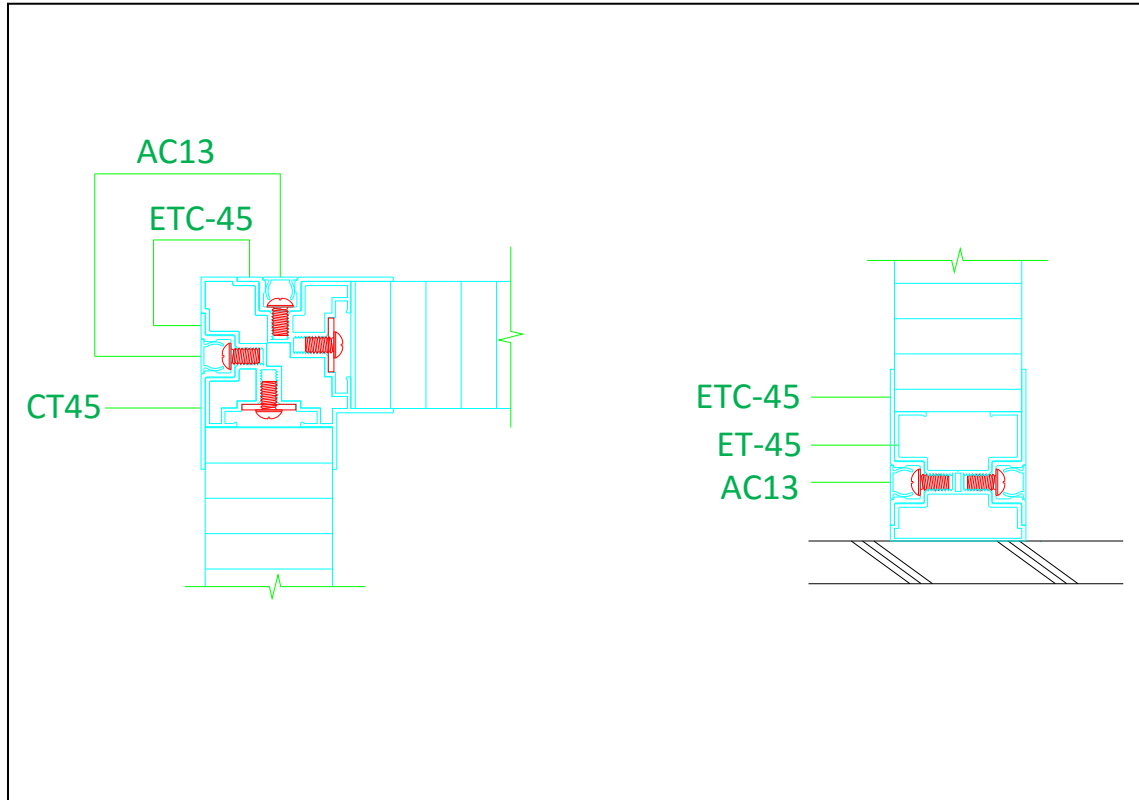

Figure 7: SFS2000 System Door & Panel Joint

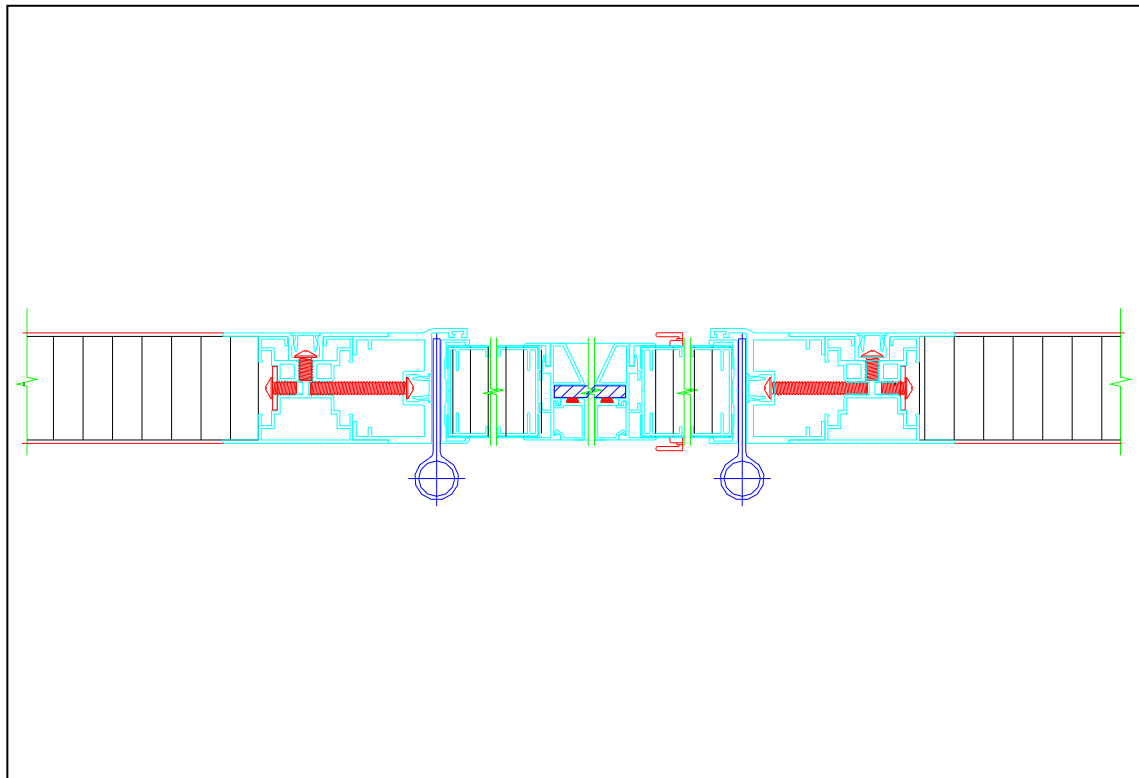

Figure 8: SFS2000 System 4.6m Height Continuous Window Wall



Figure 9: SFS2000 System – Photo Area Ball Room



Figure 10: SFS2000 System 8.5m Height with Continuous Window and Return Air Grille Opening

