

SNF2000 NON-FRAME PARTITION WALL PANEL SYSTEM

INTRODUCTION:

SNF2000 Non-Frame System is design to meet your most demanding criteria as:

1. Cost effective & value engineering
 - With SYC special design aluminium profile systems are easy to install and joint.
 - Flexible installation, can install the panel in different location to suit the project schedule, easy for installation schedule planning.
 - Lower cost design
 - High intensity aluminium honeycomb panel
 - Fast, flexible and easy installation
 - SNF2000 Non-Frame partition wall panel systems is special design for low and high end cleanroom which suitable from Class 1 to 100K
2. Superior appearance
 - Smooth color bone aluminium skin surface gives perfect appearance
3. Demountable and easy to remodel
 - Using special design profile to install, all using self-taped screw to install with each other, easy to demount and remodel
 - Easy to change the defect panel, panel-changing can done with only remove the batten between panels.
 - Panel can uninstall and remodel at other location, also easy to cut on site to fix the systems.
 - High intensity aluminium honeycomb panel. Easy for handling during remodel process.
 - Reusable system with flexible custom to size
4. Fast delivery and competitive cost
 - SYC provide the fast delivery to meet customer schedule.
 - SYC provide high quality product and reasonable price to meet customer requirement

5. Fire rated

- Approved and tested by China National Fire Department Quality Supervision Centre which the non-combustible Class B1.
- Equal to China standard GB/T9978-1999

System: Demountable wall panel system

Panel Type: 45 mm thick
Panel surrounding is without close edge or with T=0.06mm GI coated steel close edge
Combustion property, non-combustible material, according to standard GB5464

Applications: Electronics & Pharmaceutical Cleanroom

Facings: 0.5mm PE Roll Coated steel skin, with or without Static Dissipative Surface Treatment
Conductivity: $R=10^6\Omega-10^9\Omega$
The surfaces are protected with a film foil (0.05mm) for the prevention of scratches during transport and installation damages.

Color: Grey White (Close to RAL 9016)

Core: Aluminium Honeycomb, T=0.06 mm, $\varnothing=17$ mm

Adhesive: Rebon YB2002 (resin) mixed with YB8001 (Hardener) Epoxy Paste Adhesive
Mixing Ratio, YB2002:YB8001=2:1

Panel Dimension: Thickness of the panel is 45 mm.

Table 1: Honeycomb Aluminum Panel Specification

Description	Honeycomb Aluminium Panel
Non-Combustible	Class B1
Thermal Conductivity	<0.044W/mk
Resists Temperatures	>100°C
Water Absorption	Moderate
Compression Resistance	>100kPa
Aluminum Core Thickness	0.06mm
Aluminum Honeycomb Diameter	D=17mm
Compressive Strength	>200 kPa
Flammable Gas Toxicity	Moderate

The vertical joint between the panels will be sealed with SYC aluminum special design accessories (Refer to detail drawing).

Figure 1: SNF2000 System Detail Drawing

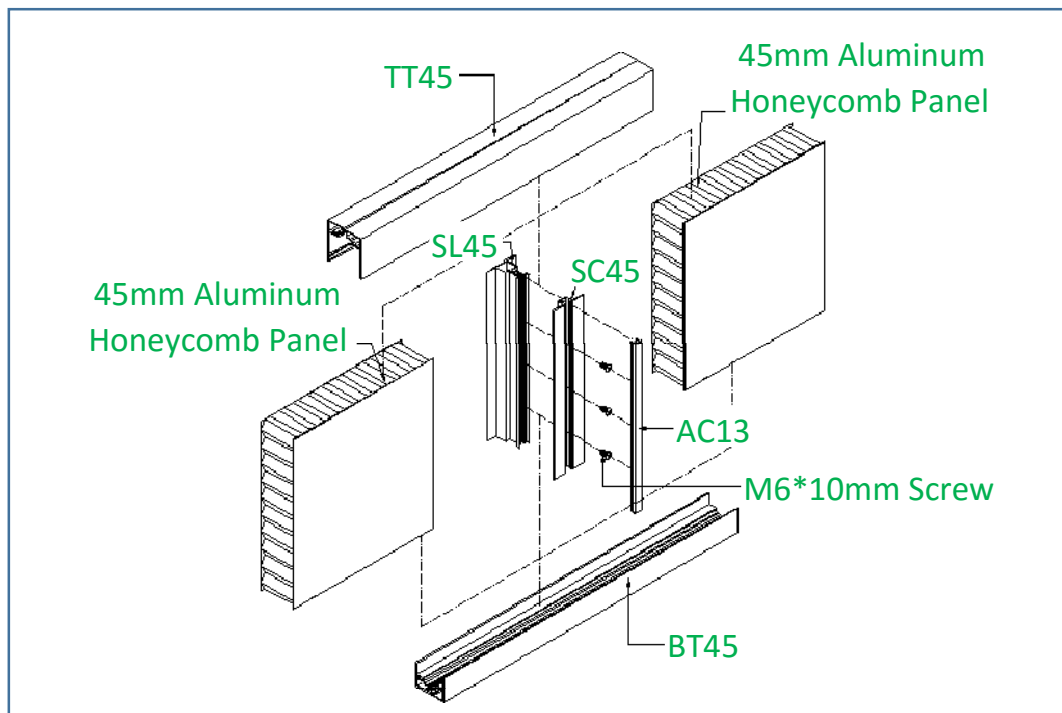

Figure 2: SNF2000 System Disassemble Drawing (Internal)



Figure 3: SNF2000 System Disassemble Drawing (External)

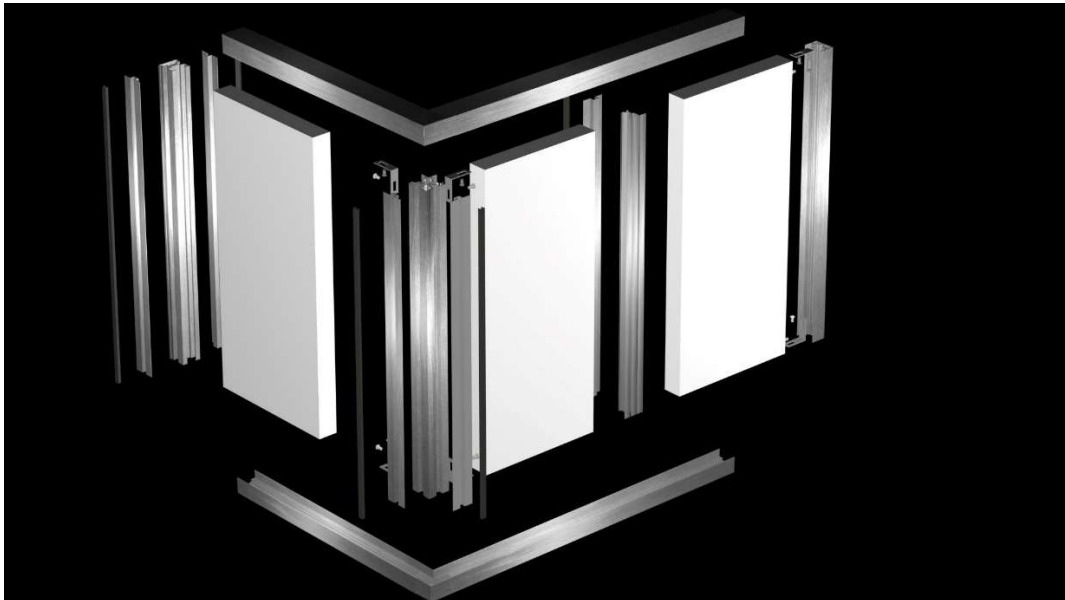

Figure 4: SNF2000 System Panel Top and Bottom Track Joint

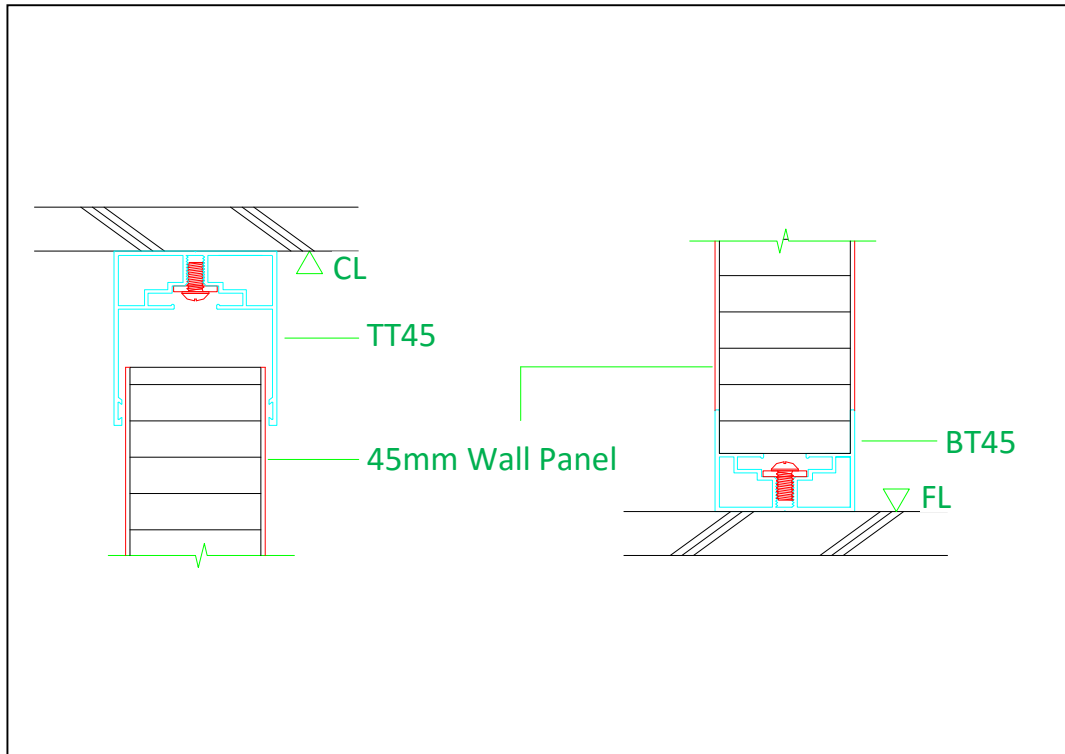

Figure 5: SNF2000 System Window & Panel Joint

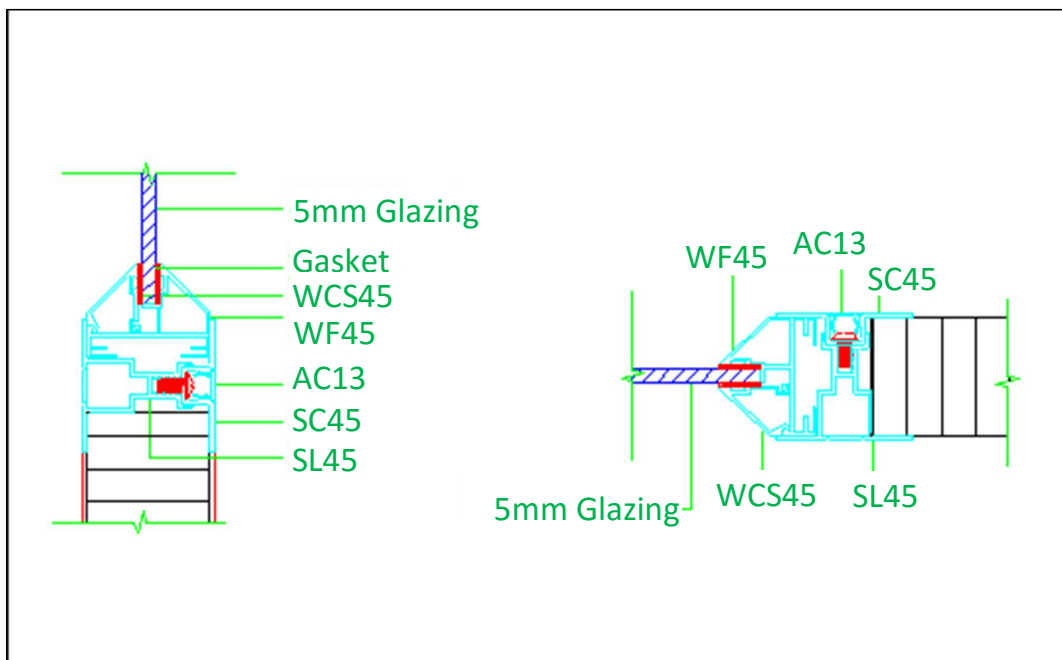

Figure 6: SNF2000 System Corner and End Post Joint

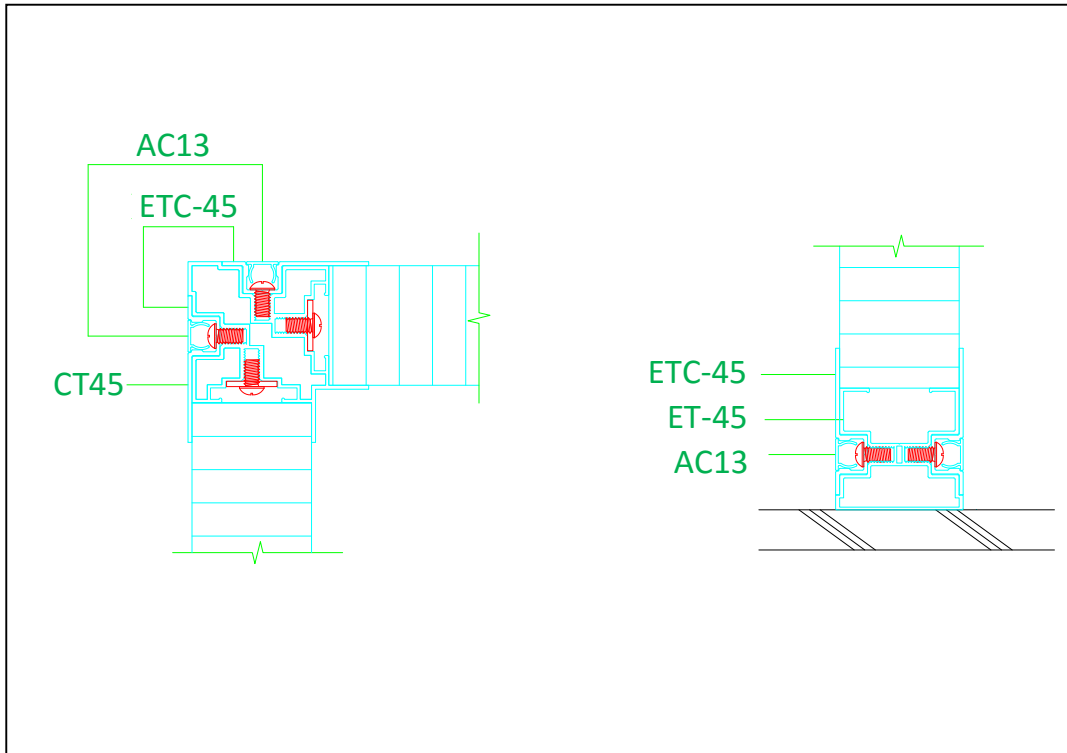

Figure 7: SNF2000 System Door & Panel Joint

